



We connect and protect

nVent Battery Energy Storage Solutions



CADDY ERICO HOFFMAN ILSCO SCHROFF TRACHTE

nVent.com

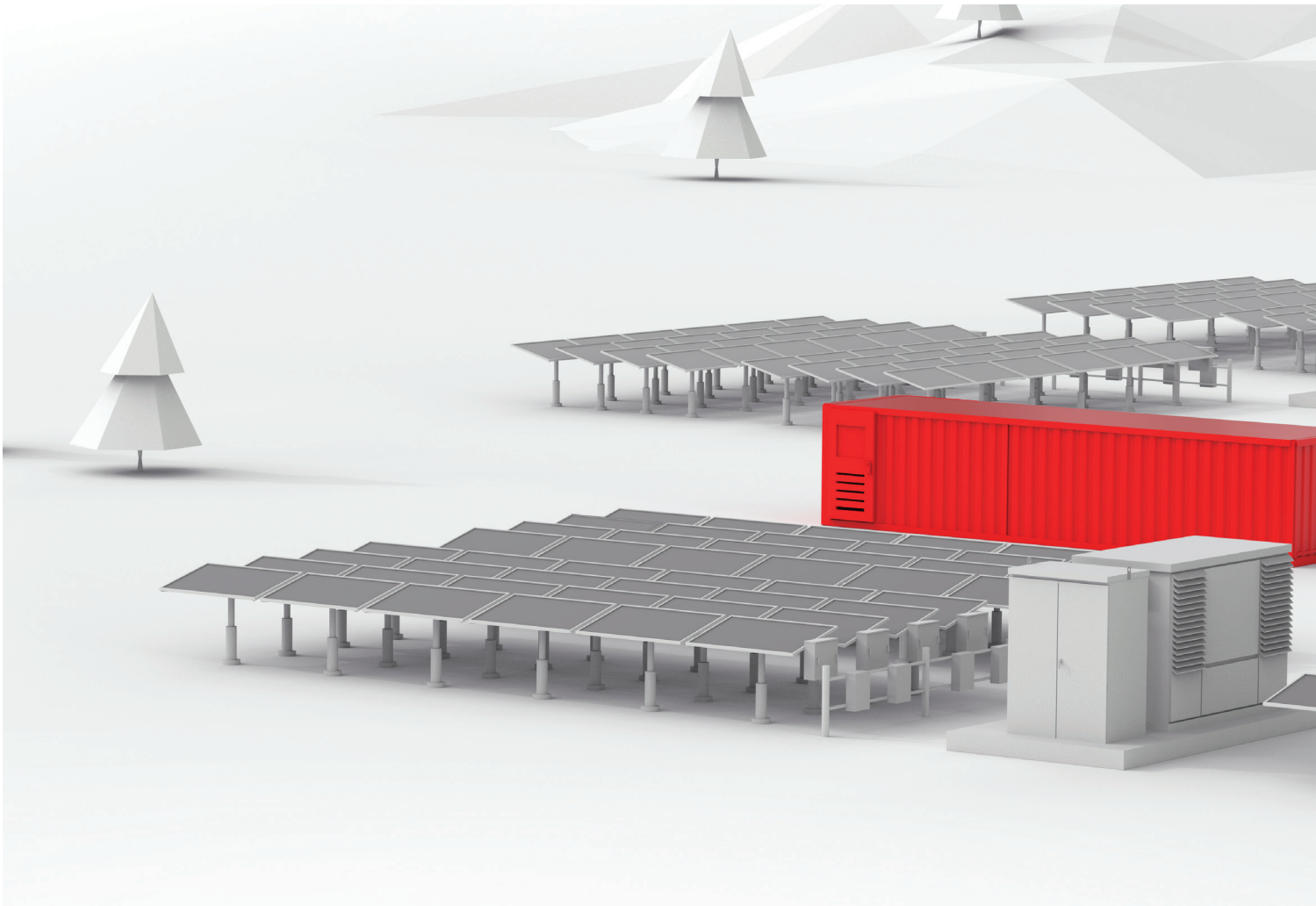

At nVent, we believe safer systems ensure a more secure world. We connect and protect our customers with inventive electrical solutions. We design, manufacture, market, install and service high performance products and solutions for mission-critical equipment, buildings and essential processes. Our solutions are helping build a more sustainable and electrified world.

Our family of brands provide innovative, global solutions for electrical connection and protection including enclosures, climate control, cable management, low-voltage connection and protection solutions, power connectors and tools, grounding and bonding components and surge devices.



Mission Critical Solutions
for Electrification



Resiliency and Safety



Customer Productivity and
Total Cost of Ownership

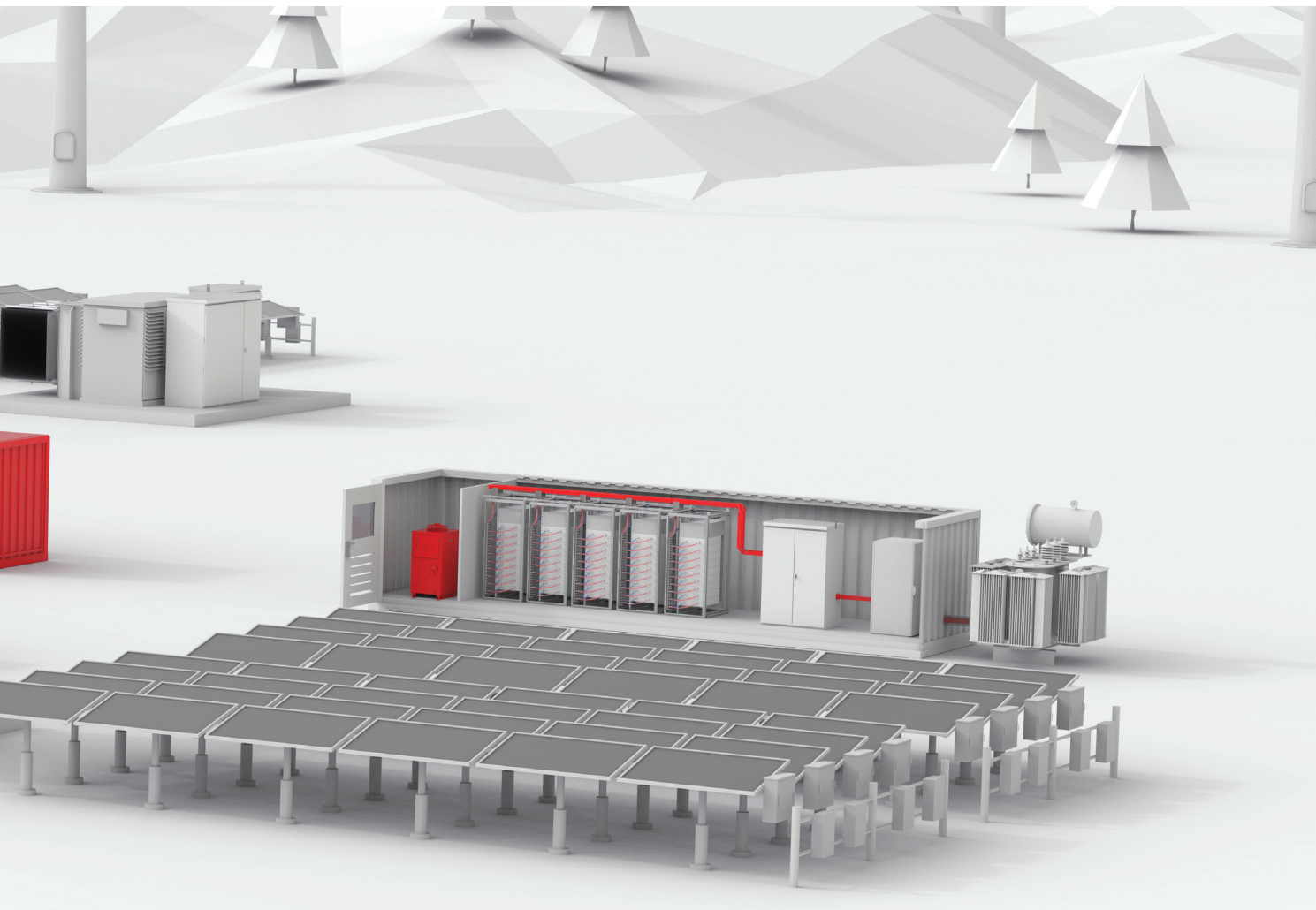

Our battery protection system simplifies design, procurement, manufacturing, and site installation while improving total cost of energy. Our solutions can be configured to meet both indoor and outdoor needs in a wide range of applications and environments.

Benefits



Scalable solutions
for all applications



Resilient protection
to maximize uptime



Maximize
energy efficiencies



Reliable, space
saving solutions



Easy
Integration



Learn more about nVent Energy Storage Solutions
<https://www.nVent.com/en-us/energy-storage>

Battery Protection System



1. BESS Enclosure

- Robust, outdoor-rated enclosure
Designed to support UL 9540
- Seismic kits
- 2-hour burn rating kit



2. Chiller

- 2.7 kW–134 kW
- Cooling precision of up to $\pm 1^{\circ}\text{F}$ ($\pm 0.5^{\circ}\text{C}$)
- Improved system reliability



3. Fluid Distribution System

- UL-listed design
- Variety of hose lengths for
easy scalability
- Seamless installation for
greater efficiency



Trusted Partner in Energy Storage Solutions



Resiliency and Protection

Our solutions add resiliency to critical systems by helping keep them safe from natural and manmade disruptions.



Lifespan and Serviceability

Our solutions extend the lifespan of our customers' systems, reducing waste and lowering cost.



Safer Solutions

Our solutions improve end-user safety and help our customers enhance the safety of their operations.



Customer Productivity

Our solutions reduce labor cost in design and installation, improve utilization and reduce total cost of ownership.

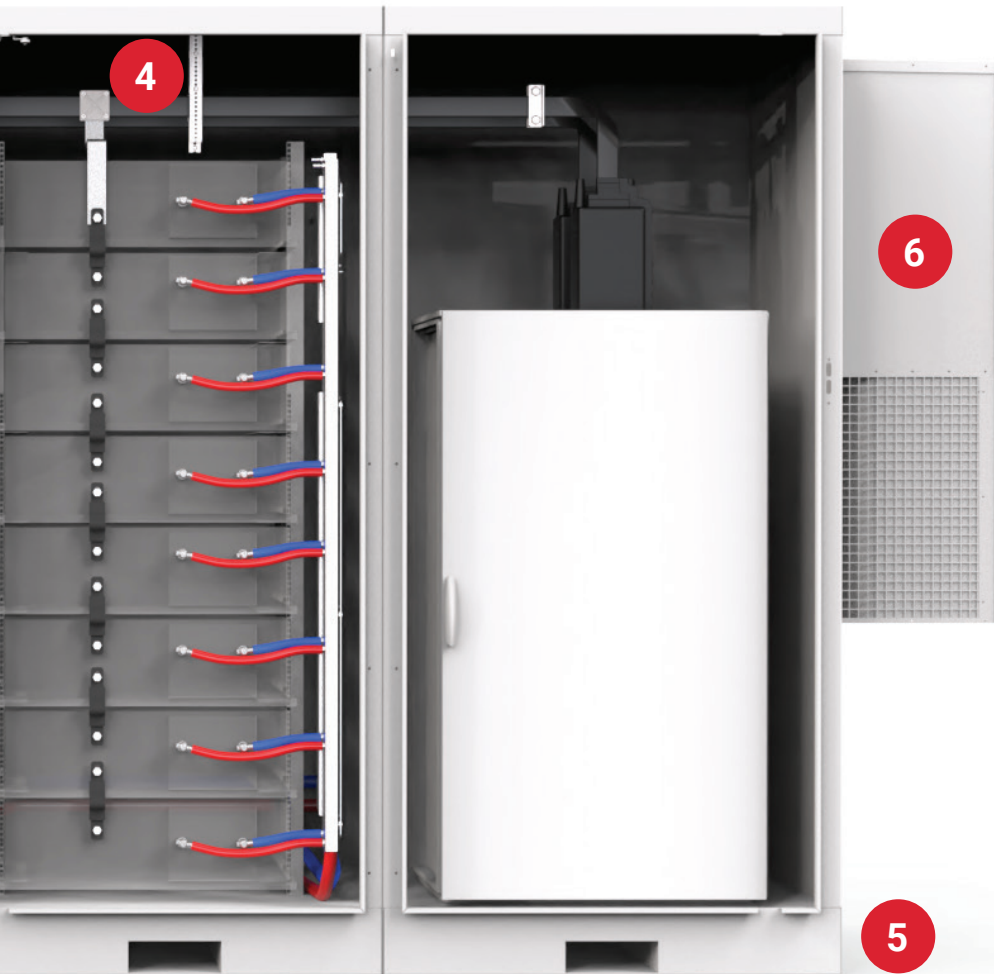

4. Electrical Distribution and Grounding

- Flexible Conductors – 80 amps to 4000 amps
- Distribution Blocks – 80 amps to 1600 amps
- Busbar Supports – up to 210 kA



5. Grounding and Bonding

- Surge – Enhanced Transit Discriminating Surge
- Grounding Neutral Busbars
- Grounding Straps – minimal impedance



6. Air Conditioner

- High-capacity indoor and outdoor rated ACs
- Eco-friendly 513 A refrigerant
- Improved reliability with robust cooling performance



Learn more about nVent Energy Storage Solutions

<https://www.nVent.com/en-us/HOFFMAN/solutions/tm-industrial/applications/utility-tool>

Electrical Connection and Protection Solutions

nVent offers a full suite of products and services that provide reliable protection to prevent damage to critical assets from unexpected surges and faults.



ELECTRICAL INFRASTRUCTURE

- Lightning Protection
- Grounding and Power Connections
 - Compression, Mechanical, Exothermic
- Ground Rods
- Power Lugs and Tools
 - Mechanical, Compression

SERVICES

- Grounding System Design Assistance
- Grounding Take-off
- Grounding Drawing Details
- Lightning Protection System Design
- Site Surveys
- Seismic Design Services
- Continuing Education for Engineers and Training



A Simpler Interconnection Solution with Flexbus



Innovative & Patented



50% Quicker Installation



20% Lower Installed Cost



Learn more about nVent Design Service & Support

<https://www.nVent.com/en-us/ERIFLEX/solutions/engineering-design-services>



Our powerful portfolio of brands:

CADDY

ERICO

HOFFMAN

ILSCO

SCHROFF

TRACHTE