

## LAMINATE TO THIRD RAIL CONNECTION KIT

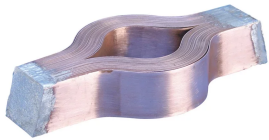

### FEATURES

Kit includes 2000 kcmil copper laminate bond, nVent ERICO Cadweld mold allocation, batting material and two units of welding material per bond connection

Allows for thermal expansion and contraction of contact rail while maintaining current flow

Attached to the inverted bottom rail with nVent ERICO Cadweld, forming a permanent low electrical resistance connection

Laminate construction for maximum flexibility

Laminates tinned together on ends to eliminate corrosion

### SPECIFICATIONS

Table 1/2

Catalog Number	Material	Rail Type	Height (H)	Width (W)	Length (L)	Minimum Order Quantity
PBK015C	Copper, Graphite, Steel	150 lb Inverted Bethlehem	31.75mm	31.75mm	177.8mm	25

Table 2/2

Catalog Number	Welding Material	Angle (a)	Conductor Size
PBK015C	SCC6001A x 2, Sold Separately	15°	2000 kcmil Laminate

## DIAGRAMS

---

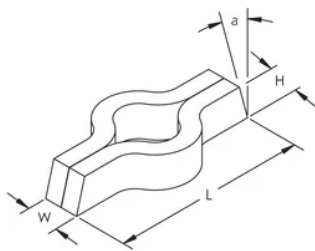

## WARNING

---

nVent products shall be installed and used only as indicated in nVent's product instruction sheets and training materials. Instruction sheets are available at [www.nvent.com](http://www.nvent.com) and from your nVent customer service representative. Improper installation, misuse, misapplication or other failure to completely follow nVent's instructions and warnings may cause product malfunction, property damage, serious bodily injury and death and/or void your warranty.



Our powerful portfolio of brands:  
**nVent.com CADDY ERICO HOFFMAN RAYCHEM SCHROFF**  
**TRACER**