

## 2 HOLE TELECOM LUG



### FEATURES

Provides an efficient bolting surface for grounding and power applications

Electrolytic grade copper

Hole spacing for telecom ground bars

For use with nVent ERICO Cadweld mold GLPCC001TC only

### SPECIFICATIONS

**Material:** Copper

**Finish:** Tinned

Table 1/2

Catalog Number	Height (H)	Width (W)	Thickness (T)	Length (L)	B	A
B922CC14A	7.93mm	15.88mm	3.18mm	47.63mm	15.88mm	9.5mm
B922CC14B	7.93mm	15.88mm	3.18mm	47.63mm	19.05mm	9.5mm
B922CC14C	7.93mm	15.88mm	3.18mm	47.63mm	25.4mm	9.5mm
B922CC38B	7.93mm	15.88mm	3.18mm	47.63mm	19.05mm	9.5mm
B922CC38C	7.93mm	15.88mm	3.18mm	47.63mm	25.4mm	9.5mm
B922CE716B	11.18mm	25.4mm	3.18mm	47.63mm	19.05mm	15.9mm

Table 2/2

Catalog Number	Angle (a)	Hole Size (HS)	Equivalent Conductor Size
----------------	-----------	----------------	---------------------------

B922CC14A	90°	7.14mm	50.39mm <sup>2</sup>
B922CC14B	90°	7.14mm	50.39mm <sup>2</sup>
B922CC14C	90°	7.14mm	50.39mm <sup>2</sup>
B922CC38B	90°	7.14mm	50.39mm <sup>2</sup>
B922CC38C	90°	7.14mm	50.39mm <sup>2</sup>
B922CE716B	90°	7.14mm	80.63mm <sup>2</sup>

### ADDITIONAL PRODUCT DETAILS

For sizes not listed, contact us.

### DIAGRAMS

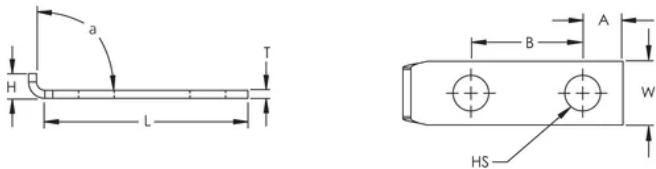

### WARNING

nVent products shall be installed and used only as indicated in nVent's product instruction sheets and training materials. Instruction sheets are available at [www.nvent.com](http://www.nvent.com) and from your nVent customer service representative. Improper installation, misuse, misapplication or other failure to completely follow nVent's instructions and warnings may cause product malfunction, property damage, serious bodily injury and death and/or void your warranty.



Our powerful portfolio of brands:  
**nVent.com CADDY ERICO HOFFMAN RAYCHEM SCHROFF**  
**TRACER**