



STRUT NUT WITHOUT SPRING



FEATURES

Used to create metal frames with nVent CADDY Eristrut channels

SPECIFICATIONS

- Static Load Safety Factor:

3:1
- Finish:

Electrogalvanized
- Material:

Steel

Table 1/1			
Catalog Number	Rod Size (RS)	Thickness (T)	Torque (TQ)
NUT0025EG	1/4"	1/4"	6 ft·lbf
NUT0037EG	3/8"	3/8"	19 ft·lbf
NUT0050EG	1/2"	1/2"	50 ft·lbf

Pull-Out Strength			
Part Number	Channel Type	Channel Thickness	
		12 GA	14 GA
NUT0025xx	A, C	450 lb	450 lb
	D, E	450 lb	-
NUT0037xx	A, C	1,100 lb	1,000 lb
	D, E	1,100 lb	-
NUT0050xx	A	2,000 lb	1,400 lb
	D, E	1,500 lb	-
NUT0062xx	A	2,000 lb	1,400 lb
	D, E	1,500 lb	-
NUT0075xx	A	2,000 lb	1,400 lb
	D, E	1,500 lb	-

DIAGRAMS

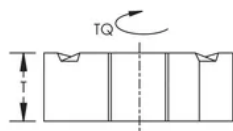
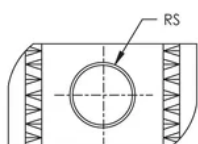

WARNING

nVent products shall be installed and used only as indicated in nVent's product instruction sheets and training materials. Instruction sheets are available at www.nvent.com and from your nVent customer service representative. Improper installation, misuse, misapplication or other failure to completely follow nVent's instructions and warnings may cause product malfunction, property damage, serious bodily injury and death and/or void your warranty.

North America

+1.800.753.9221

Option 1 – Customer Care

Option 2 – Technical Support

Europe

Netherlands:

+31 800-0200135

France:

+33 800 901 793

Europe

Germany:

800 1890272

Other Countries:

+31 13 5835404

APAC

Shanghai:

+ 86 21 2412 1618/19

Sydney:

+61 2 9751 8500



Our powerful portfolio of brands:
nVent.com CADDY ERICO HOFFMAN RAYCHEM SCHROFF
TRACER