

SBLT-800 LUG-TO-TUNNEL POWER TERMINAL



CERTIFICATIONS



FEATURES

- Tinned copper block allows for copper or aluminum conductor connections
- Accessible studs and tunnels allow for easy connection of nVent ERIFLEX Flexibar and other conductors
- Design allows for visual inspection of conductor and confirmation of connection
- Voltage detection and measurement connection
- Adjustable transparent cover
- Modular snap-together blocks for building multi-pole power blocks
- Easily clips onto DIN rail or mounts to panel with screws
- SBLEC Power Terminals Fixing Accessory required for direct panel mount
- RoHS compliant
- Halogen free

SPECIFICATIONS

Table 1/5						
Catalog Number	Article Number	Finish	Max Current Rating, IEC	Max Current Rating, UL/CSA	Short Circuit Current Rating (SCCR)	Peak Short Circuit Current (I _{pk})
SBLT-800	561146	Tinned	1250A	760A	100kA	75kA

Table 2/5						
Catalog Number	Article Number	Material	Number of Stud Connections	Stud Connection Conductor Width	Short Term Withstand Current (I _{cw}) 1s	Stud Connection Wire Size
SBLT-800	561146	Copper, Thermoplastic	2	(2) 20 – 40 mm, (1) 50 – 80 mm	57.6kA	(2) #1 - 500 kcmil

Table 3/5						
Catalog Number	Article Number	Stud Connection Compact Stranded Wire Size	Number of Tunnel Connections	Max Working Voltage, IEC (U _i)	Max Working Voltage, UL (V _{in})	Tunnel Connection Wire Size - Ferrule
SBLT-800	561146	(2) 35 – 300 mm ²	2	1000, 1500	1000	(2) 50 – 185 mm ²

Table 4/5						
Catalog Number	Article Number	Tunnel Connection Compact Stranded Wire Size	Tunnel Connection Wire Size	Height (H)	Width (W)	Depth (D)
SBLT-800	561146	(2) 95 – 240 mm ²	(2) 3/0 – 500 kcmil	205.7mm	115mm	75mm

Table 5/5						
Catalog Number	Article Number	A	Unit Weight	Flammability Rating	Certification Details	Complies With
SBLT-800	561146	108mm	1.09kg	UL® 94V-1	UL® 1059	IEC® 60947-7-1

ADDITIONAL PRODUCT DETAILS

Power terminal connections are interchangeable and can be used as line side or load side connections.

Design Guideline for Distribution Blocks, Power Blocks and Power Terminals										
Derating according to Ambient* Temperature (°C) to maintain working temperature of 85°C										
Ambient Temperature (°C)	30°	35°	40°	45°	50°	55°	60°	65°	70°	75°
Derating Coefficient (d)	1	1	1	0.94	0.88	0.82	0.75	0.67	0.58	0.47
*environment around the terminal blocks inside the enclosure										

DIAGRAMS

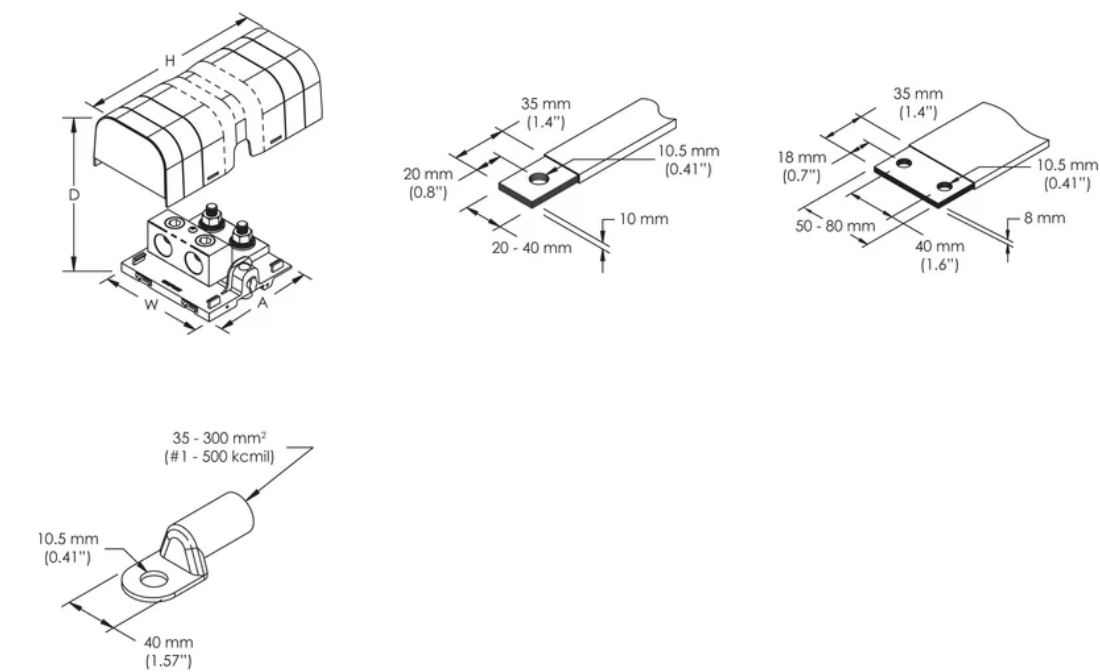

WARNING

nVent products shall be installed and used only as indicated in nVent's product instruction sheets and training materials. Instruction sheets are available at www.nvent.com and from your nVent customer service representative. Improper installation, misuse, misapplication or other failure to completely follow nVent's instructions and warnings may cause product malfunction, property damage, serious bodily injury and death and/or void your warranty.



Our powerful portfolio of brands:
nVent.com CADDY ERICO HOFFMAN RAYCHEM SCHROFF
TRACER