

## FRONT PANEL, FLAT, UNSHIELDED, D-SUB CUTOUTS



Flat front panel with cutout for D-Sub connectors. Unshielded version.

### CERTIFICATIONS



### FEATURES

Non-shielded version

Al, 2.5 mm, front anodized, rear conductive

### SPECIFICATIONS

**Accessory Type:** Front panel

Table 1/3

Catalog Number	Product Type	Type	EMC Shielding	Material	Rack Height	Front Finish
30118-341	Front Panel	Front Panel without Handle	No	Aluminum	3U	Anodized

Catalog Number	ProductType	Type	EMC Shielding	Material	Rack Height	Front Finish
30118-342	Front Panel	Front Panel without Handle	No	Aluminum	3U	Anodized
30118-343	Front Panel	Front Panel without Handle	No	Aluminum	3U	Anodized
30118-344	Front Panel	Front Panel without Handle	No	Aluminum	3U	Anodized
30118-345	Front Panel	Front Panel without Handle	No	Aluminum	3U	Anodized
30118-346	Front Panel	Front Panel without Handle	No	Aluminum	3U	Anodized
30118-347	Front Panel	Front Panel without Handle	No	Aluminum	3U	Anodized

Table 2/3						
Catalog Number	Rear Finish	Height (H)	Treated Edges	Rack Width	Width (W)	Depth (D)
30118-341	Conductive	128.4mm	No	4HP	19.98mm	2.5mm
30118-342	Conductive	128.4mm	No	4HP	19.98mm	2.5mm
30118-343	Conductive	128.4mm	No	4HP	19.98mm	2.5mm
30118-344	Conductive	128.4mm	No	4HP	19.98mm	2.5mm
30118-345	Conductive	128.4mm	No	4HP	19.98mm	2.5mm
30118-346	Conductive	128.4mm	No	4HP	19.98mm	2.5mm
30118-347	Conductive	128.4mm	No	4HP	19.98mm	2.5mm

Table 3/3				
Catalog Number	Mounting	Complies With	Package Quantity	Finish
30118-341	Screw-on Front	IEC 60297-3-101, IEEE 1101.1/10	1	Anodized, Passivated
30118-342	Screw-on Front	IEC 60297-3-101, IEEE 1101.1/10	1	Anodized, Passivated
30118-343	Screw-on Front	IEC 60297-3-101, IEEE 1101.1/10	1	Anodized, Passivated
30118-344	Screw-on Front	IEC 60297-3-101, IEEE 1101.1/10	1	Anodized, Passivated
30118-345	Screw-on Front	IEC 60297-3-101, IEEE 1101.1/10	1	Anodized, Passivated
30118-346	Screw-on Front	IEC 60297-3-101, IEEE 1101.1/10	1	Anodized, Passivated
30118-347	Screw-on Front	IEC 60297-3-101, IEEE 1101.1/10	1	Anodized, Passivated

ADDITIONAL PRODUCT DETAILS

Delivery is in standard pack multiples. Pricing is per individual item.

Please order fixing material (sleeves, collar screws) separately.

Please take into consideration that deliveries may be carried out in the stated SPQs (SPQ, e.g. 5 pieces, 10 pieces, 50 pieces, etc.). Differing order quantities (e.g. 2 pieces) may be changed to the next possible delivery quantity = Standard Pack Quantity.

DIAGRAMS

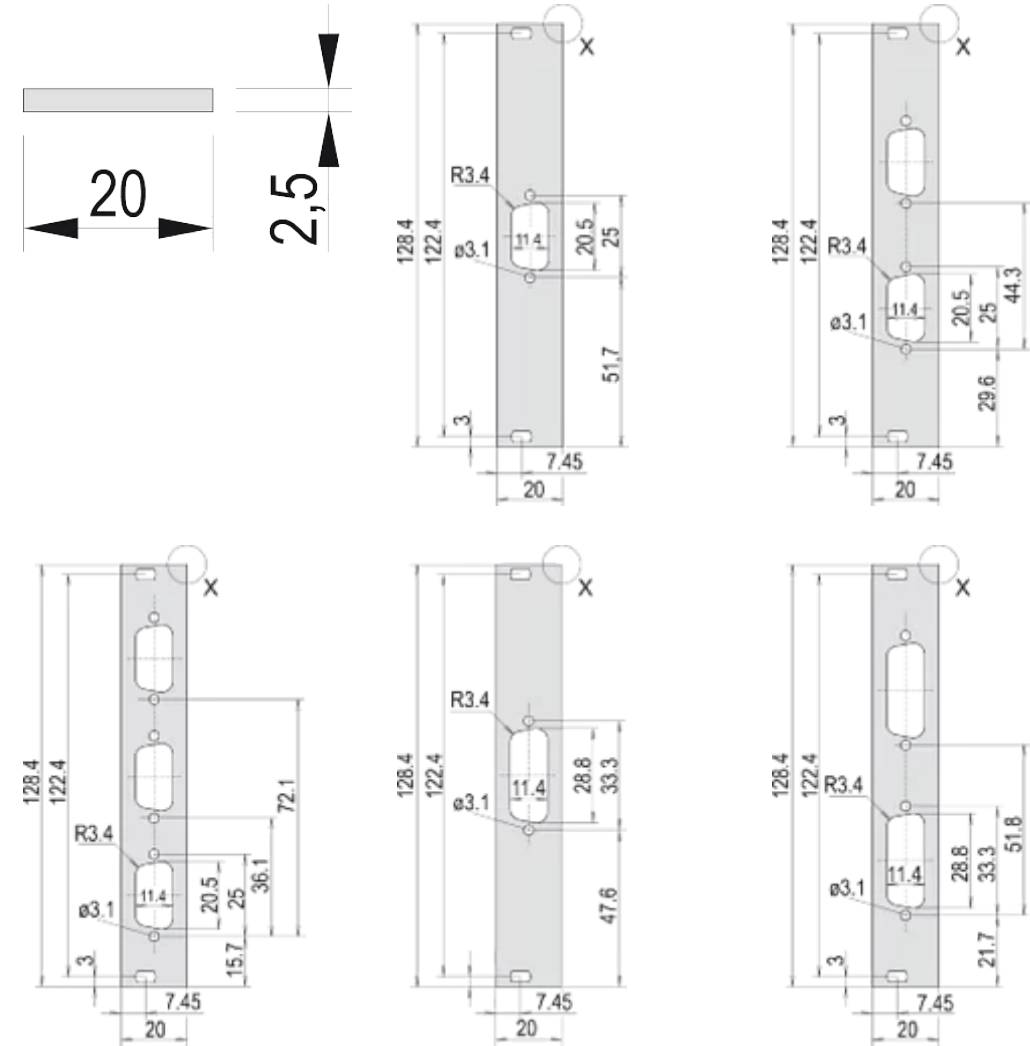

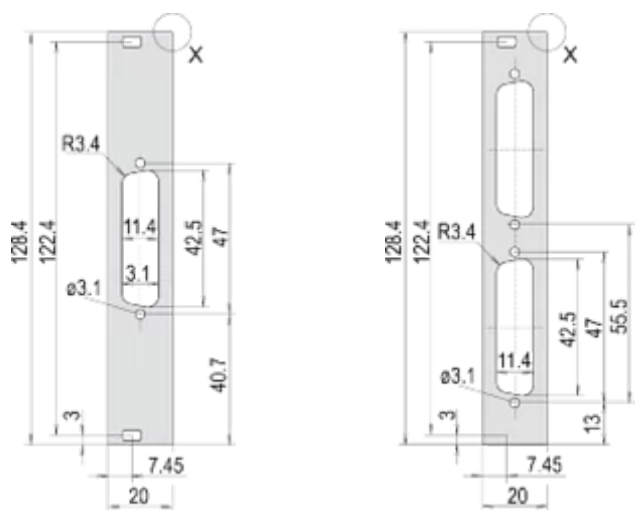

## WARNING

nVent products shall be installed and used only as indicated in nVent's product instruction sheets and training materials. Instruction sheets are available at [www.nvent.com](http://www.nvent.com) and from your nVent customer service representative. Improper installation, misuse, misapplication or other failure to completely follow nVent's instructions and warnings may cause product malfunction, property damage, serious bodily injury and death and/or void your warranty.

### North America

All locations  
+1.763.422.2661  
Chat with us:  
[schroff.nvent.com](http://schroff.nvent.com)

### Europe

Straubenhardt, Germany  
+49.7082.794.0  
Betschdorf, France  
+33.3.88.90.64.90  
Warsaw, Poland  
+48.22.209.98.35  
Assago, Italy  
+39.02.932.7141  
Chat with us:  
[schroff.nvent.com](http://schroff.nvent.com)

### Asia

Shanghai, China  
+86.21.2412.6943  
Qingdao, China  
+86.532.8771.6101  
Singapore  
+65.6768.5800  
Shin-Yokohama, Japan  
+81.45.476.0271  
Chat with us:  
[schroff.nvent.com](http://schroff.nvent.com)

### Middle East & India

Dubai, United Arab Emirates  
+971.4.378.1700  
Bangalore, India  
+91.80.6715.2001  
Istanbul, Turkey  
+90.216.250.7374  
Chat with us:  
[schroff.nvent.com](http://schroff.nvent.com)



Our powerful portfolio of brands:  
**nVent.com CADDY ERICO HOFFMAN RAYCHEM SCHROFF**  
**TRACER**