

1 HOLE LUG, GL STYLE, 36.576 MM X 25.4 MM X 3.18 MM, 14.29 MM HOLE

CATALOG NUMBER

B121CE



FEATURES

Provides an efficient bolting surface for grounding and power applications

Electrolytic grade copper

For use with nVent ERICO Cadweld type GL connections only

PRODUCT ATTRIBUTES

Article Number: 183650

Material: Copper

Finish: Tinned

Type: NEMA®

Height (H): 11.18mm

Length (L): 36.58mm

Width (W): 25.4mm

Thickness (T): 3.18mm

A: 15.9mm

Hole Size (HS): 14.29mm

Angle (a): 90°

Equivalent Conductor Size: 80.63mm²

ADDITIONAL PRODUCT DETAILS

For sizes not listed, contact us.

DIAGRAMS

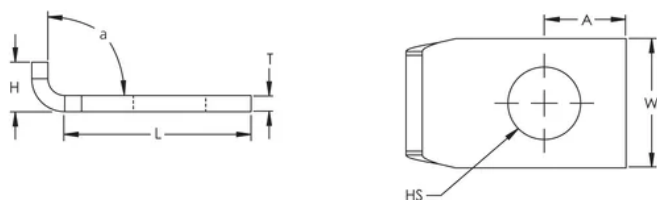

WARNING

nVent products shall be installed and used only as indicated in nVent's product instruction sheets and training materials. Instruction sheets are available at www.nvent.com and from your nVent customer service representative. Improper installation, misuse, misapplication or other failure to completely follow nVent's instructions and warnings may cause product malfunction, property damage, serious bodily injury and death and/or void your warranty.



Our powerful portfolio of brands:
nVent.com CADDY ERICO HOFFMAN RAYCHEM SCHROFF
TRACER