

# STAMPED SECONDARY CONNECTOR



## CERTIFICATIONS



## FEATURES

Use to bond sheet metal bodies such as gutters or fixed ladders to the lightning protection system

## SPECIFICATIONS

**Conductor Size, UL:** Secondary;Class 1

**Finish:** Tinned

Table 1/1

Catalog Number	Material	Depth (D)	Height (H)	Width (W)	Unit Weight
LPA508	Aluminum	38.1mm	31.75 mm	38.1 mm	0.04 kg
LPC508L	Copper	38.1mm	31.75 mm	38.1 mm	0.06 kg

DIAGRAMS

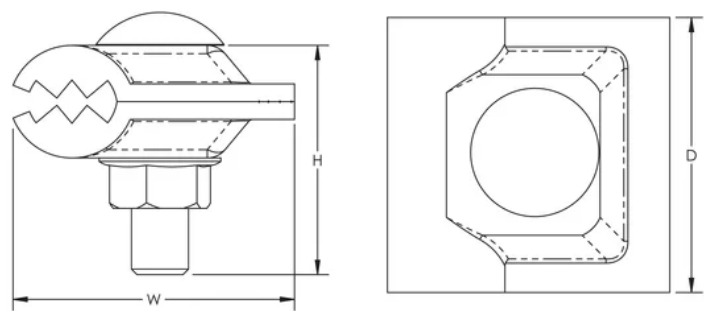

WARNING

nVent products shall be installed and used only as indicated in nVent's product instruction sheets and training materials. Instruction sheets are available at [www.nvent.com](http://www.nvent.com) and from your nVent customer service representative. Improper installation, misuse, misapplication or other failure to completely follow nVent's instructions and warnings may cause product malfunction, property damage, serious bodily injury and death and/or void your warranty.

North America

+1.800.753.9221  
Option 1 – Customer Care  
Option 2 – Technical Support

Europe

Netherlands:  
+31 800-0200135  
France:  
+33 800 901 793

Europe

Germany:  
800 1890272  
Other Countries:  
+31 13 5835404

APAC

Shanghai:  
+ 86 21 2412 1618/19  
Sydney:  
+61 2 9751 8500



Our powerful portfolio of brands:  
**nVent.com CADDY ERICO HOFFMAN RAYCHEM SCHROFF**  
**TRACER**