

CAST SECONDARY BONDING LUG

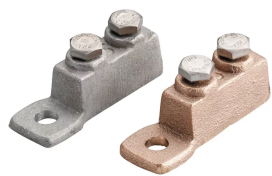

CERTIFICATIONS



FEATURES

- Cast terminal bonding lug with two bolt tension on secondary conductors
- Use to connect metal objects such as ladders and drains to lightning protection system

SPECIFICATIONS

- Finish:** Bare
- Conductor Size, UL:** Secondary

Table 1/1						
Catalog Number	Material	Hole Size (HS)	Depth (D)	Height (H)	Width (W)	Unit Weight
LPA555	Aluminum	7.9 mm	19.05mm	19.8 mm	60.33 mm	0.04 kg
LPC555	Brass	7.9 mm	19.05mm	19.8 mm	60.33 mm	0.1 kg

ADDITIONAL PRODUCT DETAILS

For use with secondary bonding cables and wires up to 0.3" (7.62 mm) in diameter.

DIAGRAMS

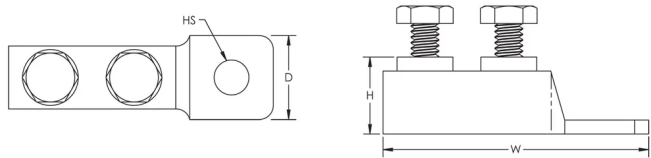

WARNING

nVent products shall be installed and used only as indicated in nVent's product instruction sheets and training materials. Instruction sheets are available at www.nvent.com and from your nVent customer service representative. Improper installation, misuse, misapplication or other failure to completely follow nVent's instructions and warnings may cause product malfunction, property damage, serious bodily injury and death and/or void your warranty.

⚠ WARNING: This product can expose you to chemicals including lead, which is known to the State of California to cause cancer and birth defects or other reproductive harm. For more information go to www.P65Warnings.ca.gov.

North America

+1.800.753.9221
Option 1 – Customer Care
Option 2 – Technical Support

Europe

Netherlands:
+31 800-0200135
France:
+33 800 901 793

Europe

Germany:
800 1890272
Other Countries:
+31 13 5835404

APAC

Shanghai:
+ 86 21 2412 1618/19
Sydney:
+61 2 9751 8500



Our powerful portfolio of brands:
nVent.com CADDY ERICO HOFFMAN RAYCHEM SCHROFF
TRACER