

SIGN SUPPORT BRACKET FOR FLAT SURFACE, ONE HOLE



FEATURES

Straight leg design, should be used when mounting on a flat surface

Attachment support for Fixoband

Stainless steel washers and bolts included

SPECIFICATIONS

Table 1/1

Catalog Number	Article Number	Material	Hole Size (HS)	Hole Type	A
FXB21S2	350110	Stainless Steel 302 (EN 1.4324)	8 mm	Threaded	20 mm

DIAGRAMS

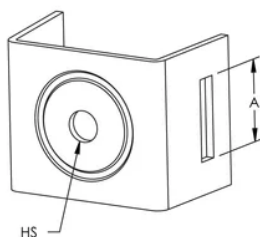

WARNING

nVent products shall be installed and used only as indicated in nVent's product instruction sheets and training materials. Instruction sheets are available at www.nvent.com and from your nVent customer service representative. Improper installation, misuse, misapplication or other failure to completely follow nVent's instructions and warnings may cause product malfunction, property damage, serious bodily injury and death and/or void your warranty.

North America

+1.800.753.9221
Option 1 – Customer Care
Option 2 – Technical Support

Europe

Netherlands:
+31 800-0200135
France:
+33 800 901 793

Europe

Germany:
800 1890272
Other Countries:
+31 13 5835404

APAC

Shanghai:
+ 86 21 2412 1618/19
Sydney:
+61 2 9751 8500



Our powerful portfolio of brands:
nVent.com CADDY ERICO HOFFMAN RAYCHEM SCHROFF
TRACER