



FOUR HOLE EXTERNAL COUPLER



FEATURES

Used to create metal frames with nVent CADDY Eristrut channels

SPECIFICATIONS

Finish: Hot-Dip Galvanized

Material: Steel

Table 1/2

Catalog Number	Article Number	Strut Type	Hole Size (HS)	Thickness (T)	A	B
ZUA406	387810	C (21 x 41 mm)	13 mm	6 mm	184 mm	20 mm
ZUA407	387820	A (41 x 41 mm)	13 mm	6 mm	184 mm	20 mm

Table 2/2

Catalog Number	Article Number	C
ZUA406	387810	48 mm
ZUA407	387820	48 mm

DIAGRAMS

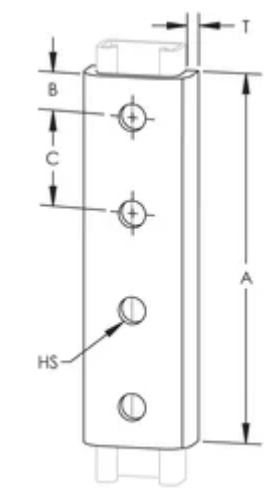

WARNING

nVent products shall be installed and used only as indicated in nVent's product instruction sheets and training materials. Instruction sheets are available at www.nvent.com and from your nVent customer service representative. Improper installation, misuse, misapplication or other failure to completely follow nVent's instructions and warnings may cause product malfunction, property damage, serious bodily injury and death and/or void your warranty.

North America
+1.800.753.9221
Option 1 – Customer Care
Option 2 – Technical Support

Europe
Netherlands:
+31 800-0200135
France:
+33 800 901 793

Europe
Germany:
800 1890272
Other Countries:
+31 13 5835404

APAC
Shanghai:
+ 86 21 2412 1618/19
Sydney:
+61 2 9751 8500



Our powerful portfolio of brands:

nVent.com **CADDY ERICO HOFFMAN RAYCHEM SCHROFF**
TRACER