



PX NI HD PIPE CLAMP W/EXT. THREAD, S316, 100–105 MM OD, 1/2" THREAD, 31 MM

CATALOG NUMBER

PXN105S6



FEATURES

Includes male/female combination nut

Heavy duty

PRODUCT ATTRIBUTES

Article Number: 577600

Nut Included: Yes

Material: Stainless Steel 316 (EN 1.4401)

Outer Diameter (OD): 100 - 105 mm

Pipe Size: 3 1/2"

Rod Size (RS): 10

Gewinde (G): 1/2"

Width (W): 31 mm

Thickness (T): 2 mm

Screw Diameter (Sc): 8

Screw Length (L): 25mm

Static Load (F): 2500N

DIAGRAMS

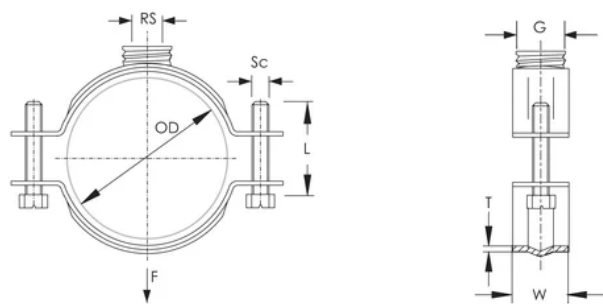

WARNING

nVent products shall be installed and used only as indicated in nVent's product instruction sheets and training materials. Instruction sheets are available at www.nvent.com and from your nVent customer service representative. Improper installation, misuse, misapplication or other failure to completely follow nVent's instructions and warnings may cause product malfunction, property damage, serious bodily injury and death and/or void your warranty.

North America

+1.800.753.9221
Option 1 – Customer Care
Option 2 – Technical Support

Europe

Netherlands:
+31 800-0200135
France:
+33 800 901 793

Europe

Germany:
800 1890272
Other Countries:
+31 13 5835404

APAC

Shanghai:
+ 86 21 2412 1618/19
Sydney:
+61 2 9751 8500



Our powerful portfolio of brands:
nVent.com CADDY ERICO HOFFMAN RAYCHEM SCHROFF
TRACER