

CAVITY PLUG



FEATURES

For use in plasterboard, hollow brick, hollow block and chipboard

Ideal for attachment to cavity walls

Large seating area for high loading capacity

SPECIFICATIONS

Finish: Electrogalvanized

Material: Steel

Screw Included: Yes

Table 1/2

Catalog Number	Article Number	Screw Diameter (Sc)	Screw Length (L)	Drill Bit Diameter	A	B
MFV433	571460	4	41mm	8mm	3 - 10 mm	12 mm
MFV537	571470	5	46mm	10mm	5 - 14 mm	12 mm
MFV650	571510	6	59mm	12mm	6 - 17 mm	21 mm

Table 2/2

Catalog Number	Article Number	Ultimate Static Load 1 (F1)	Ultimate Static Load 2 (F2)
MFV433	571460	200N	200N
MFV537	571470	200N	200N

Catalog Number	Article Number	Ultimate Static Load 1 (F1)	Ultimate Static Load 2 (F2)
MFV650	571510	200N	250N

ADDITIONAL PRODUCT DETAILS

Refer to Ultimate Static Load 1 when anchor is set in plasterboard. Refer to Ultimate Static Load 2 when anchor is set in hollow block or hollow cinder block.

DIAGRAMS

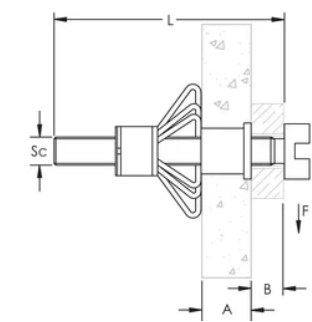

WARNING

nVent products shall be installed and used only as indicated in nVent's product instruction sheets and training materials. Instruction sheets are available at www.nvent.com and from your nVent customer service representative. Improper installation, misuse, misapplication or other failure to completely follow nVent's instructions and warnings may cause product malfunction, property damage, serious bodily injury and death and/or void your warranty.

North America +1.800.753.9221 Option 1 – Customer Care Option 2 – Technical Support	Europe Netherlands: +31 800-0200135 France: +33 800 901 793	Europe Germany: 800 1890272 Other Countries: +31 13 5835404	APAC Shanghai: + 86 21 2412 1618/19 Sydney: +61 2 9751 8500
---	--	--	--