

## 1 HOLE LUG, GL STYLE



### FEATURES

Provides an efficient bolting surface for grounding and power applications

Electrolytic grade copper

For use with nVent ERICO Cadweld type GL connections only

### SPECIFICATIONS

**Material:** Copper

**Type:** NEMA®

**Finish:** Tinned

Table 1/2

Catalog Number	Article Number	Height (H)	Width (W)	Thickness (T)	Length (L)	A
B121CE	183650	11.18mm	25.4mm	3.18mm	36.58mm	15.9mm
B121QQ		11mm	25.4mm	3.2mm	38.5mm	16mm
B121DE		11.18mm	25.4mm	4.76mm	37.34mm	15.9mm
B121SQ		11mm	25.4mm	4.76mm	36.5mm	16mm
B121EE		11.18mm	25.4mm	6.35mm	38.1mm	15.9mm
B121EG		11.18mm	38.1mm	6.35mm	38.1mm	15.9mm

Table 2/2

Catalog Number	Article Number	Angle (a)	Hole Size (HS)	Equivalent Conductor Size
----------------	----------------	-----------	----------------	---------------------------

B121CE	183650	90°	14.29mm	80.63mm <sup>2</sup>
B121QQ		90°	14.3mm	81mm <sup>2</sup>
B121DE		105°	14.29mm	120.94mm <sup>2</sup>
B121SQ		90°	14mm	121mm <sup>2</sup>
B121EE		135°	14.29mm	161.26mm <sup>2</sup>
B121EG		135°	14.29mm	241.89mm <sup>2</sup>

## ADDITIONAL PRODUCT DETAILS

For sizes not listed, contact us.

## DIAGRAMS

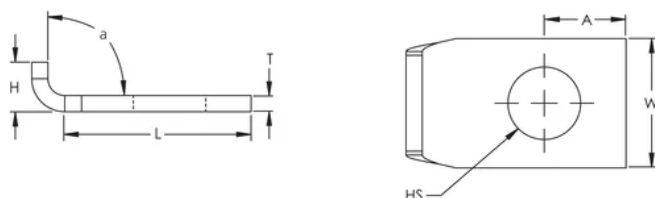

## WARNING

nVent products shall be installed and used only as indicated in nVent's product instruction sheets and training materials. Instruction sheets are available at [www.nvent.com](http://www.nvent.com) and from your nVent customer service representative. Improper installation, misuse, misapplication or other failure to completely follow nVent's instructions and warnings may cause product malfunction, property damage, serious bodily injury and death and/or void your warranty.



Our powerful portfolio of brands:  
**nVent.com CADDY ERICO HOFFMAN RAYCHEM SCHROFF**  
**TRACER**