



## 2-2 HOLE OPEN CORNER ANGLE BRACKET



### FEATURES

Used to create metal frames with nVent CADDY Eristrut channels

### SPECIFICATIONS

**Finish:** Hot-Dip Galvanized

**Material:** Steel

Table 1/2

Catalog Number	Article Number	Angle (a)	B	C	Hole Size (HS)	Thickness (T)
ZW220	313700	45 °	87 mm	87 mm	14	6
ZWA220	387980	45 °	87 mm	87 mm	14	6

Table 2/2

Catalog Number	Article Number	Screw Diameter (Sc)	Screw Length (L)	Screw Included
ZW220	313700	10	25mm	Yes
ZWA220	387980			No

DIAGRAMS

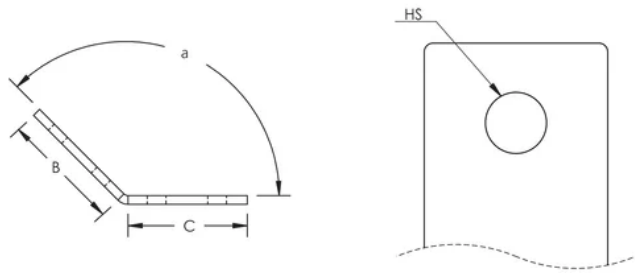

WARNING

nVent products shall be installed and used only as indicated in nVent's product instruction sheets and training materials. Instruction sheets are available at [www.nvent.com](http://www.nvent.com) and from your nVent customer service representative. Improper installation, misuse, misapplication or other failure to completely follow nVent's instructions and warnings may cause product malfunction, property damage, serious bodily injury and death and/or void your warranty.

North America

+1.800.753.9221  
Option 1 – Customer Care  
Option 2 – Technical Support

Europe

Netherlands:  
+31 800-0200135  
France:  
+33 800 901 793

Europe

Germany:  
800 1890272  
Other Countries:  
+31 13 5835404

APAC

Shanghai:  
+ 86 21 2412 1618/19  
Sydney:  
+61 2 9751 8500



Our powerful portfolio of brands:  
**nVent.com CADDY ERICO HOFFMAN RAYCHEM SCHROFF**  
**TRACER**