

## RACKCHILLER IN-ROW COOLER GANGING KIT

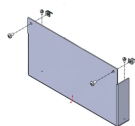

The RackChiller In-Row Ganging kit allows for integration of the cooler into Proline or Varistar aisle containments. The included levelling feet, plinth and top blanking panel assure seamless look while providing best sealing properties of the aisle containment. The kit is available in different variations, depending on the cooler and racks used.

### FEATURES

Seamlessly integrates the Rack-Chiller In-Row into aisle containments

Including plinth, levelling feet and top blanking panel

### SPECIFICATIONS

Table 1/2

| Catalog Number | Product Type | Product Family | Rack Height | Works With        | Width | Color Code |
|----------------|--------------|----------------|-------------|-------------------|-------|------------|
| 21630-175      | Mounting Kit | RackChiller    | 42U         | Aisle Containment | 300mm | RAL 7021   |
| 21630-176      | Mounting Kit | RackChiller    | 38U         | Aisle Containment | 300mm | RAL 7021   |

Table 2/2

| Catalog Number | Color      | Material | Finish        | Package Quantity |
|----------------|------------|----------|---------------|------------------|
| 21630-175      | Black Grey | Steel    | Powder Coated | 1                |
| 21630-176      | Black Grey | Steel    | Powder Coated | 1                |

### WARNING

nVent products shall be installed and used only as indicated in nVent's product instruction sheets and training materials. Instruction sheets are available at [www.nvent.com](http://www.nvent.com) and from your nVent customer service representative. Improper installation, misuse, misapplication or other failure to completely follow nVent's instructions and warnings may cause product malfunction, property damage, serious bodily injury and death and/or void your warranty.



Our powerful portfolio of brands:  
**nVent.com CADDY ERICO HOFFMAN RAYCHEM SCHROFF**  
**TRACER**