



NVENT CADDY SPEED LINK SLK WITH Y-TOGGLE



CERTIFICATIONS



FEATURES

- Complete system includes wire, locking device and two pre-assembled toggle end fittings
- Attaches to clearance holes in a variety of structures or hanging devices
- Ideal for supporting lighting fixtures

SPECIFICATIONS

Static Load Safety Factor:	5:1
Finish:	Electrogalvanized
Material:	Steel;Zinc Alloy;Polypropylene
Complies With:	SMACNA HVAC-DCS

Table 1/2						
Catalog Number	Article Number	Wire Rope Diameter	Wire Rope Length	Wire Rope "Y" Length (YL)	A	B
SLK15Y300L3R 2	196648	1.5 mm	3m	0.3m	39 mm	5 mm
SLK15Y500L3	196528	1.5 mm	3m	0.5m	39 mm	5 mm

Catalog Number	Article Number	Wire Rope Diameter	Wire Rope Length	Wire Rope "Y" Length (YL)	A	B
SLK2Y300L7	196556	2 mm	7m	0.3m	42 mm	8 mm
SLK2Y500L3	196554	2 mm	3m	0.5m	42 mm	8 mm

Table 2/2

Catalog Number	Article Number	Static Load (F)	Packing Quantity
SLK15Y300L3R2	196648	195N	2.0000
SLK15Y500L3	196528	195N	1.0000
SLK2Y300L7	196556	440N	1.0000
SLK2Y500L3	196554	440N	1.0000

Thickness (T): 12.5 mm

Width (W): 19 mm

Height (H): 55 mm

Angle (a): 90 ° Max

DIAGRAMS

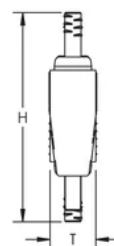
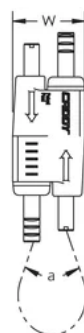
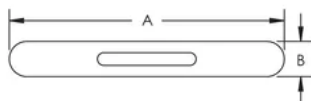
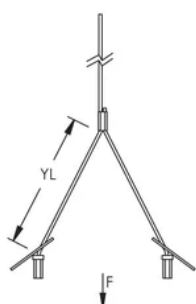

WARNING

nVent products shall be installed and used only as indicated in nVent's product instruction sheets and training materials. Instruction sheets are available at www.nvent.com and from your nVent customer service representative. Improper installation, misuse, misapplication or other failure to completely follow nVent's instructions and warnings may cause product malfunction, property damage, serious bodily injury and death and/or void your warranty.

North America

+1.800.753.9221

Option 1 – Customer Care

Option 2 – Technical Support

Europe

Netherlands:

+31 800-0200135

France:

+33 800 901 793

Europe

Germany:

800 1890272

Other Countries:

+31 13 5835404

APAC

Shanghai:

+ 86 21 2412 1618/19

Sydney:

+61 2 9751 8500



Our powerful portfolio of brands:
nVent.com CADDY ERICO HOFFMAN RAYCHEM SCHROFF
TRACER