

MAST TO AIR TERMINAL ADAPTOR



FEATURES

Connects Conventional Air Terminal to SIM series Stainless Steel Mast

SPECIFICATIONS

Table 1/2						
Catalog Number	Material	Thread Size 2 (TS2)	Thread Size 1 (TS1)	Diameter (Ø)	Length 1 (L1)	A
INTCPTMI16AT	Stainless Steel 304L (EN 1.4306)	M25	M16	28.6mm	25mm	52mm

Table 2/2	
Catalog Number	Length 2 (L2)
INTCPTMI16AT	24mm

DIAGRAMS

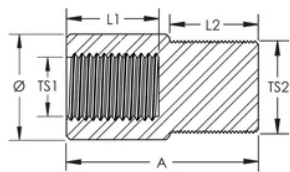

WARNING

nVent products shall be installed and used only as indicated in nVent's product instruction sheets and training materials. Instruction sheets are available at www.nvent.com and from your nVent customer service representative. Improper installation, misuse, misapplication or other failure to completely follow nVent's instructions and warnings may cause product malfunction, property damage, serious bodily injury and death and/or void your warranty.



Our powerful portfolio of brands:
nVent.com CADDY ERICO HOFFMAN RAYCHEM SCHROFF
TRACER