

UNIVERSAL SWAY BRACE



The nVent CADDY Universal Sway Brace is an innovative, versatile solution providing seismic bracing for suspended pipes. Featuring a unique slotted hole pattern for easy slip-on installation, installers can eliminate the risk and inconvenience of loose hardware, making it an ideal choice for ensuring safety and compliance on the job.

CERTIFICATIONS



FEATURES

Used for both lateral and longitudinal sway brace applications

Snap-off bolt head helps enable easy installation and inspection

Works with 1" to 2" (25,4mm to 50,8mm) brace pipes to reduce inventory

Works with 12 gauge or thicker Type A solid strut as brace member

Meets NFPA®-13 and CEN/TS 1755:2021 requirements for seismic sway bracing

FM Approved with the following brace members: Type A Solid Strut (12 gauge or thicker) and 1-2 in Sch40/EN 10255H Pipe

FM Specification Tested with the following brace members: Type A Solid Strut (12 gauge or thicker) and 1-2 in Sch40/EN 10255H Pipe

SPECIFICATIONS

Material: Steel

Table 1/3

Catalog Number	Article Number	Finish	Pipe Size, Nominal (Ø)	Pipe Size, Nominal	Cast Iron	NB/DN
----------------	----------------	--------	------------------------	--------------------	-----------	-------

CSB0100HDN		Hot-Dip Galvanized				25
CSB0100N		Electrogalvanized	1in	25.4mm		25
CSB0125HDN		Hot-Dip Galvanized				32
CSB0125N		Electrogalvanized	1.25in	31.75mm		32
CSB0400HDN		Hot-Dip Galvanized				100
CSB0400N		Electrogalvanized	4in	101.6mm	101.6mm	100
CSB0150HDN		Hot-Dip Galvanized				40
CSB0150N		Electrogalvanized	1.5in	38.1mm	38.1mm	40
CSB0200HDN		Hot-Dip Galvanized				50
CSB0200N		Electrogalvanized	2in	50.8mm	50.8mm	50
CSB0250HDN		Hot-Dip Galvanized				65
CSB0250N		Electrogalvanized	2.5in	63.5mm	63.5mm	65
CSB1200	404551	Electrogalvanized	12in	304.8mm	304.8mm	300
CSB0300HDN		Hot-Dip Galvanized				80
CSB0300N		Electrogalvanized	3in	76.2mm	76.2mm	80
CSB0500HDN		Hot-Dip Galvanized				125
CSB0500N		Electrogalvanized	5in			125
CSB1000HDN		Hot-Dip Galvanized				250
CSB1000N		Electrogalvanized	10in	254mm	254mm	250
CSB1200HDN		Hot-Dip Galvanized	12in	304.8mm	304.8mm	300
CSB1200N		Electrogalvanized	12in	304.8mm	304.8mm	300

CSB0600HDN		Hot-Dip Galvanized				150
CSB0600N		Electrogalvanized	6in	152.4mm		150
CSB0800HDN		Hot-Dip Galvanized				200
CSB0800N		Electrogalvanized	8in	203.2mm	203.2mm	200

Table 2/3						
Catalog Number	Article Number	Brace Pipe Size	Brace NB/DN	Width (W)	A	C
CSB0100HDN		1 – 2in	25 – 50mm	38mm	91mm	16mm
CSB0100N		1 – 2in	25 – 50mm	38mm	91mm	16mm
CSB0125HDN		1 – 2in	25 – 50mm	38mm	91mm	18mm
CSB0125N		1 – 2in	25 – 50mm	38mm	91mm	18mm
CSB0400HDN		1 – 2in	25 – 50mm	38mm	91mm	26mm
CSB0400N		1 – 2in	25 – 50mm	38mm	91mm	26mm
CSB0150HDN		1 – 2in	25 – 50mm	38mm	91mm	19mm
CSB0150N		1 – 2in	25 – 50mm	38mm	91mm	19mm
CSB0200HDN		1 – 2in	25 – 50mm	38mm	91mm	21mm
CSB0200N		1 – 2in	25 – 50mm	38mm	91mm	21mm
CSB0250HDN		1 – 2in	25 – 50mm	38mm	91mm	24mm
CSB0250N		1 – 2in	25 – 50mm	38mm	91mm	24mm
CSB1200	404551	1 – 2in	25 – 50mm	38mm	91mm	25mm
CSB0300HDN		1 – 2in	25 – 50mm	38mm	91mm	25mm
CSB0300N		1 – 2in	25 – 50mm	38mm	91mm	25mm
CSB0500HDN		1 – 2in	25 – 50mm	38mm	91mm	25mm
CSB0500N		1 – 2in	25 – 50mm	38mm	91mm	25mm
CSB1000HDN		1 – 2in	25 – 50mm	38mm	91mm	25mm
CSB1000N		1 – 2in	25 – 50mm	38mm	91mm	25mm
CSB1200HDN		1 – 2in	25 – 50mm	38mm	91mm	25mm
CSB1200N		1 – 2in	25 – 50mm	38mm	91mm	25mm
CSB0600HDN		1 – 2in	25 – 50mm	38mm	91mm	29mm
CSB0600N		1 – 2in	25 – 50mm	38mm	91mm	29mm
CSB0800HDN		1 – 2in	25 – 50mm	38mm	91mm	31mm
CSB0800N		1 – 2in	25 – 50mm	38mm	91mm	31mm

Table 3/3

Catalog Number	Article Number	B	D	Certifications
CSB0100HDN		33mm	126mm	
CSB0100N		33mm	126mm	
CSB0125HDN		33mm	140mm	
CSB0125N		33mm	140mm	
CSB0400HDN		33mm	216mm	
CSB0400N		33mm	216mm	
CSB0150HDN		33mm	136mm	
CSB0150N		33mm	136mm	
CSB0200HDN		33mm	151mm	
CSB0200N		33mm	151mm	
CSB0250HDN		33mm	171mm	
CSB0250N		33mm	171mm	
CSB1200	404551	33mm	429mm	OSHDP/HCAI, FM Approved, Seismic
CSB0300HDN		33mm	187mm	
CSB0300N		33mm	187mm	
CSB0500HDN		33mm	255mm	
CSB0500N		33mm	255mm	
CSB1000HDN		33mm	386mm	
CSB1000N		33mm	386mm	
CSB1200HDN		33mm	429mm	
CSB1200N		33mm	429mm	
CSB0600HDN		33mm	275mm	
CSB0600N		33mm	275mm	
CSB0800HDN		33mm	331mm	
CSB0800N		33mm	331mm	

ADDITIONAL PRODUCT DETAILS

FM® Specification Tested for 1-1/2 in to 4 in pipe sizes using no hub cast iron pipe.

Load ratings for Sch 10 may also be applied to AS 1074 Medium, GB/T 3091, EN 10255 (Medium or Heavy), and JIS G3452 pipe.

Load ratings for Sch 40 may also be applied to AS 1074 Heavy, GB/T 3091, EN 10255 (Heavy), and JIS G3454 pipe.

Load ratings for FM approved lightwall may also be applied to AS 1074 Lightwall, EN 10255 L, EN 10220, and GB/T 8163 pipe.

FM Approved with 12 gauge or thicker Type A solid strut as brace member

UL Loads								
Part Number	Lateral				Longitudinal			
	Sch 10/Sch 40 Service Pipe	Bull Moose Eddy Flow Service Pipe	Wheatland Mega-Flow Service Pipe	Youngstown Fire-Flo Service Pipe	Sch 10/Sch 40 Service Pipe	Bull Moose Eddy Flow Service Pipe	Wheatland Mega-Flow Service Pipe	Youngstown Fire-Flo Service Pipe
CSB0100xxx	8006 N	N/A	N/A	N/A	4448 N	N/A	N/A	N/A
CSB0125xxx	8006 N	8006 N	8006 N	N/A	3025 N	3025 N	3025 N	N/A
CSB0150xxx	8006 N	8006 N	8006 N	8006 N	4448 N	4448 N	4448 N	4448 N
CSB0200xxx	8006 N	8006 N	8006 N	8006 N	5782 N	5782 N	5782 N	5782 N
CSB0250xxx	8006 N	8006 N	8006 N	8006 N	5782 N	5782 N	5782 N	5782 N
CSB0300xxx	8006 N	8006 N	8006 N	8006 N	6227 N	6227 N	6227 N	6227 N
CSB0400xxx	8006 N	8006 N	8006 N	8006 N	7561 N	7561 N	7561 N	7561 N
CSB0500xxx	8006 N	N/A	N/A	N/A	7561 N	N/A	N/A	N/A
CSB0600xxx	8006 N	N/A	8006 N	N/A	7561 N	N/A	7561 N	N/A
CSB0800xxx	8006 N	N/A	N/A	N/A	7561 N	N/A	N/A	N/A
CSB1000xxx	8451 N	N/A	N/A	N/A	8451 N	N/A	N/A	N/A
CSB1200xxx	N/A	N/A	N/A	N/A	N/A	N/A	N/A	N/A

FM Loads								
Part Number	Horizontal Capacity per Installation Angle from Vertical							
	Lateral				Longitudinal			
	30° - 44°	45° - 59°	60° - 74°	75° - 90°	30° - 44°	45° - 59°	60° - 74°	75° - 90°
FM Approved Lightwall, Sch 10 and Sch 40 Service Pipes								
CSB0100xxx	6620 N	9380 N	11470 N	12890 N	5730 N	5510 N	5600 N	6220 N
CSB0125xxx	6130 N	8710 N	10670 N	11960 N	5730 N	5510 N	5600 N	6220 N
CSB0150xxx	6130 N	8710 N	10670 N	11960 N	5330 N	8270 N	9690 N	10000 N
CSB0200xxx	6130 N	8710 N	10670 N	11960 N	5330 N	8090 N	9690 N	10000 N
CSB0250xxx	6400 N	9020 N	11070 N	12410 N	5870 N	8090 N	9740 N	11120 N
CSB0300xxx	6180 N	8760 N	10760 N	12050 N	5780 N	7960 N	9740 N	11120 N
CSB0400xxx	6180 N	8760 N	10760 N	12050 N	5780 N	7960 N	9740 N	11120 N
CSB0500xxx	6180 N	8760 N	10760 N	12050 N	5780 N	7960 N	9740 N	11120 N
CSB0600xxx	6490 N	9160 N	11200 N	12580 N	6270 N	8670 N	10450 N	11920 N
0.188" Wall and Sch 40 Service Pipes								
CSB0800xxx	5910 N	8360 N	10230 N	11470 N	6220 N	8540 N	10450 N	11740 N
CSB1000xxx	5910 N	8360 N	10230 N	11470 N	6220 N	8540 N	10450 N	11740 N
CSB1200xxx	7470 N	10540 N	12940 N	14500 N	7110 N	8270 N	9960 N	11520 N

DIAGRAMS

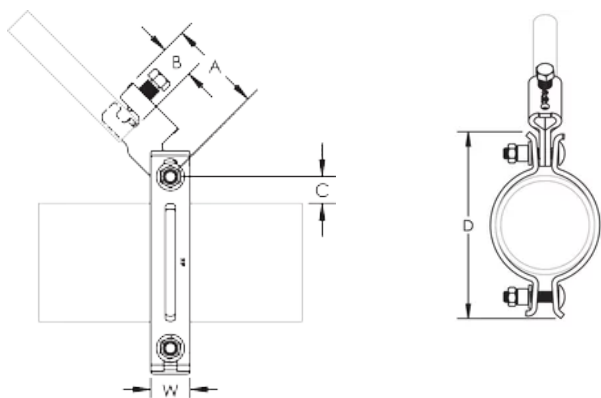

WARNING

nVent products shall be installed and used only as indicated in nVent's product instruction sheets and training materials. Instruction sheets are available at www.nvent.com and from your nVent customer service representative. Improper installation, misuse, misapplication or other failure to completely follow nVent's instructions and warnings may cause product malfunction, property damage, serious bodily injury and death and/or void your warranty.



Our powerful portfolio of brands:
nVent.com CADDY ERICO HOFFMAN RAYCHEM SCHROFF
TRACER