

ADJUSTABLE I-BEAM ADAPTER



This code-compliant Structural Attachment is part of the nVent CADDY line of innovative rigid bracing system, designed to provide superior performance and meet the highest seismic load requirements. Its innovative design allows quick and easy installation onto a wide range of steel I-Beams. It is ready to use out of the box, eliminating the need for pre-assembly or loose hardware and its snap-off bolts make inspection of seismic sway braces simple.

CERTIFICATIONS



FEATURES

No loose parts

No assembly required

Snap-off bolt head helps enable easy installation and inspection of seismic sway braces

Meets NFPA®-13 requirements for seismic sway bracing

FM® Specification Tested

SPECIFICATIONS

Finish: Electrogalvanized

Material: Steel

Table 1/2

Catalog Number	Article Number	Flange Thickness (FT)	Rod Size 1 (RS1)	Rod Size 2 (RS2)	Height (H)	Width (W)
CSBS3	404507	6 – 19mm	3/8" in	1/2" in	67mm	92mm
CSBS4	404508	6 – 19mm	3/8" in	1/2" in	67mm	92mm

Catalog Number	Article Number	Flange Thickness (FT)	Rod Size 1 (RS1)	Rod Size 2 (RS2)	Height (H)	Width (W)
CSBS3N	404129	6 – 19mm	3/8" in	1/2" in	67mm	92mm
CSBS4N	404131	6 – 19mm	3/8" in	1/2" in	67mm	92mm
CSBS5	404509	19 – 31mm	3/8" in	1/2" in	79mm	92mm
CSBS5N	404133	19 – 31mm	3/8" in	1/2" in	79mm	92mm

Table 2/2			
Catalog Number	Article Number	A	Certifications
CSBS3	404507	100 – 215mm	cUL, UL, OSHPD/HCAI, FM Approved, Seismic
CSBS4	404508	100 – 365mm	cUL, UL, OSHPD/HCAI, FM Approved, Seismic
CSBS3N	404129	100 – 215mm	
CSBS4N	404131	100 – 365mm	
CSBS5	404509	100 – 455mm	cUL, UL, OSHPD/HCAI, FM Approved, Seismic
CSBS5N	404133	100 – 455mm	

ADDITIONAL PRODUCT DETAILS

Structure Attachment and Brace Member are not included.

UL Loads				
Part Number	Structure Attachment Fitting	Flange Thickness	Brace Member	Load Rating
CSBS3xxx	CSBU1xxx	6 - 8 mm	DN25 - DN50 Sch. 40 NPS	6672 N
		8 - 19 mm		7561 N
	CSBURC12	6 - 19 mm	CSB12CBL	1859 N
			CSB18CBL	3434 N
			CSB36CBL	4893 N
CSBS4xxx	CSBU1xxx	6 - 8 mm	DN25 - DN50 Sch. 40 NPS	6672 N
		8 - 19 mm		7561 N
	CSBURC12	6 - 19 mm	CSB12CBL	1859 N
			CSB18CBL	3434 N
			CSB36CBL	4893 N
	CSBURC12	6 - 19 mm	CSB12CBL	1859 N
			CSB18CBL	3434 N
			CSB36CBL	4893 N

FM Loads								
Part Number	Horizontal Capacity per Installation Angle from Vertical							
	Perpendicular to Structure				Parallel to Structure			
	30°- 44°	45°- 59°	60°- 74°	75°- 90°	30°- 44°	45°- 59°	60°- 74°	75°- 90°
CSBS3xxx	5240 N	9830 N	12580 N	13070 N	3640 N	6130 N	9250 N	13380 N
CSBS4xxx	5240 N	9830 N	12580 N	13070 N	3640 N	6130 N	9250 N	13380 N
CSBS5xxx	5420 N	9510 N	11470 N	12760 N	4890 N	8090 N	9740 N	11920 N

DIAGRAMS

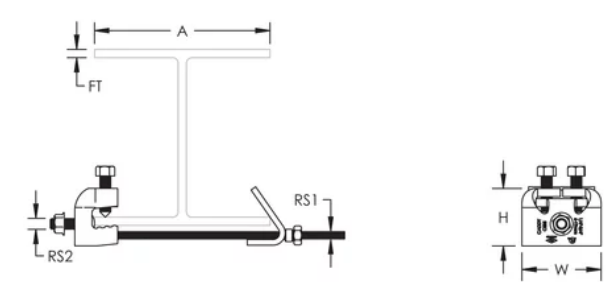

WARNING

nVent products shall be installed and used only as indicated in nVent's product instruction sheets and training materials. Instruction sheets are available at www.nvent.com and from your nVent customer service representative. Improper installation, misuse, misapplication or other failure to completely follow nVent's instructions and warnings may cause product malfunction, property damage, serious bodily injury and death and/or void your warranty.



Our powerful portfolio of brands:

nVent.com
CADDY
ERICO
HOFFMAN
RAYCHEM
SCHROFF

TRACER