

## 4 HOLE LUG



### FEATURES

Provides an efficient bolting surface for grounding and power applications

Electrolytic grade copper

For use with nVent ERICO Cadweld type LA connections only

### SPECIFICATIONS

**Material:** Copper

**Type:** NEMA®

**Finish:** Tinned

Table 1/2

Catalog Number	Width (W)	Thickness (T)	Length (L)	B	A	Hole Size (HS)
B104EK	76.2mm	6.35mm	114.3mm	44.5mm	15.9mm	14.29mm
B104GK	76.2mm	9.53mm	120.65mm	44.5mm	15.9mm	14.29mm
B104JK	76.2mm	12.7mm	120.65mm	44.5mm	15.9mm	14.29mm
B104JK003	76.2mm	12.7mm	177.8mm	44.5mm	25.4mm	14.29mm

Table 2/2

Catalog Number	Equivalent Conductor Size
B104EK	483.77mm <sup>2</sup>
B104GK	725.66mm <sup>2</sup>
B104JK	967.54mm <sup>2</sup>

Catalog Number	Equivalent Conductor Size
B104JK003	967.54mm <sup>2</sup>

### ADDITIONAL PRODUCT DETAILS

For sizes not listed, contact us.

### DIAGRAMS

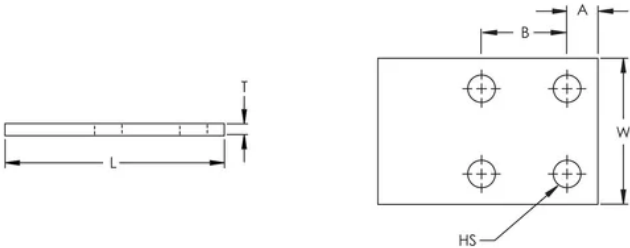

### WARNING

nVent products shall be installed and used only as indicated in nVent's product instruction sheets and training materials. Instruction sheets are available at [www.nvent.com](http://www.nvent.com) and from your nVent customer service representative. Improper installation, misuse, misapplication or other failure to completely follow nVent's instructions and warnings may cause product malfunction, property damage, serious bodily injury and death and/or void your warranty.



Our powerful portfolio of brands:  
**nVent.com CADDY ERICO HOFFMAN RAYCHEM SCHROFF**  
**TRACER**