

MAST TO AIR TERMINAL ADAPTOR

CATALOG NUMBER

INTCPTMI16AT



FEATURES

Connects Conventional Air Terminal to SIM series Stainless Steel Mast

PRODUCT ATTRIBUTES

Material: Stainless Steel 304L (EN 1.4306)

A: 52mm

Diameter (Ø): 28.6mm

Length 1 (L1): 25mm

Length 2 (L2): 24mm

Thread Size 1 (TS1): M16

Thread Size 2 (TS2): M25

DIAGRAMS

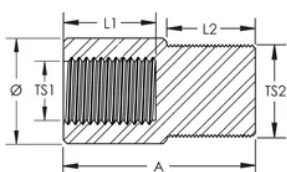

WARNING

nVent products shall be installed and used only as indicated in nVent's product instruction sheets and training materials. Instruction sheets are available at www.nvent.com and from your nVent customer service representative. Improper installation, misuse, misapplication or other failure to completely follow nVent's instructions and warnings may cause product malfunction, property damage, serious bodily injury and death and/or void your warranty.



Our powerful portfolio of brands:
nVent.com CADDY ERICO HOFFMAN RAYCHEM SCHROFF
TRACER