

## 4 HOLE OFFSET LUG



### FEATURES

Provides an efficient bolting surface for grounding and power applications

Electrolytic grade copper

For use with nVent ERICO Cadweld type LA connections only

### SPECIFICATIONS

**Material:** Copper

**Type:** NEMA®

**Finish:** Tinned

Table 1/2

Catalog Number	Height (H)	Width (W)	Thickness (T)	Length (L)	C	B
B104EKOL	39.62mm	76.2mm	6.35mm	152.4mm	85.7mm	44.5mm
B104GKOL	39.62mm	76.2mm	9.53mm	158.75mm	92.1mm	44.5mm
B104JKOL	39.62mm	76.2mm	12.7mm	158.75mm	92.1mm	44.5mm

Table 2/2

Catalog Number	A	D	Angle (a)	Hole Size (HS)	Equivalent Conductor Size
B104EKOL	15.9mm	44.5mm	45°	14.29mm	483.77mm <sup>2</sup>
B104GKOL	15.9mm	44.5mm	45°	14.29mm	725.66mm <sup>2</sup>
B104JKOL	15.9mm	44.5mm	45°	14.29mm	967.54mm <sup>2</sup>

## ADDITIONAL PRODUCT DETAILS

For sizes not listed, contact us.

## DIAGRAMS

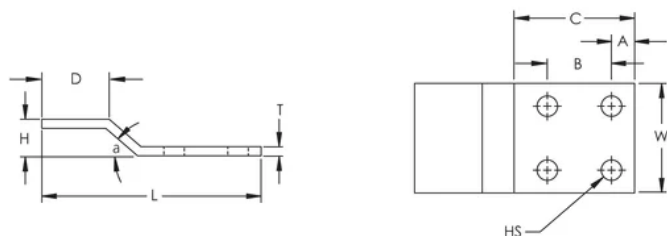

## WARNING

nVent products shall be installed and used only as indicated in nVent's product instruction sheets and training materials. Instruction sheets are available at [www.nvent.com](http://www.nvent.com) and from your nVent customer service representative. Improper installation, misuse, misapplication or other failure to completely follow nVent's instructions and warnings may cause product malfunction, property damage, serious bodily injury and death and/or void your warranty.



Our powerful portfolio of brands:  
**nVent.com CADDY ERICO HOFFMAN RAYCHEM SCHROFF**  
**TRACER**